



Ducted Entry Boot

SINGLE WALL RIGID ENTRY BOOTS

APT® ducted and non-ducted rigid entry boots allow you to connect XP double wall flexible pipe to single wall containment sumps with an unsurpassed level of installation ease, while also completely removing exposed rubber from the connection. The interior pipe seal compresses onto the pipe, providing watertight connections between the boot and pipe. This durable entry boot requires only a single 5" entry hole for installation, eliminating the time-consuming process of drilling multiple holes as well as the templates they require.

HIGHLIGHTS

- Available in 1½", 1¾", and 2" models for use with APT® XP double wall flexible pipe.
- Suitable for use with flat and round sump surfaces, with polyethylene or fiberglass containment.
- Flexible ducting connectors are made from an oil and gasoline-resistant Nitrile rubber and employ stainless steel band clamps for maximum corrosion resistance.
- The body, clamp plate, and compression nut material are all glass-filled nylon, and the face and pipe seal material is Nitrile 1502.
- A simple design including only five parts (nine parts for ducted applications) makes for an easy installation process. The ducted model comes complete with flexible ducting connectors and three clamps.
- An integrated clamp plate allows you to seal the boot in place on the sump wall simply by tightening with a spanner wrench. Once tightened, the boot's gasketed face seal compresses into place providing a watertight connection between the boot and the sump surface. The interior ridges of the boot guide pipe into place to ensure a proper 90° entry into the containment sump, with an interior length of 3¼".

SPECIFICATIONS

Approvals/Certifications

- ULc listed when installed with APT® ULc listed sumps.

Components

- 1 Compression nut
- 2 Compression insert
- 3 Pipe seal
- 4 Pipe guide
- 5 Entry boot flange
- 6 Body

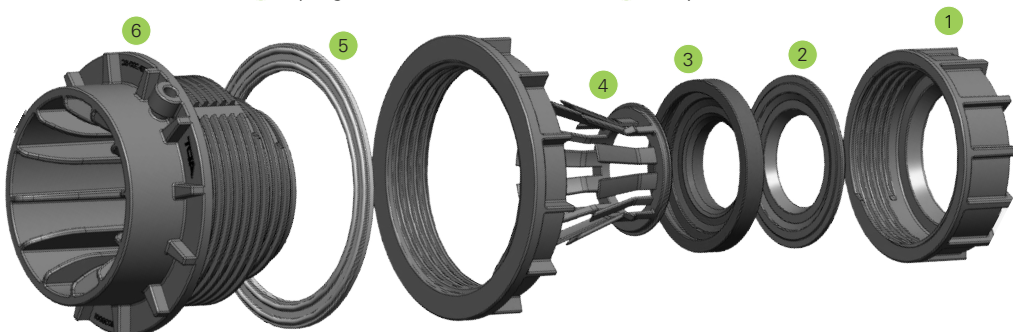

ORDERING INFORMATION

Model	Description
REB-150-SC	1½" rigid entry boot for flat sump surfaces
RDEB-150-SC	1½" ducted rigid entry boot for flat sump surfaces
REB-R-150-SC	1½" rigid entry boot for round sump surfaces
RDEB-R-150-SC	1½" ducted rigid entry boot for round sump surfaces
REB-175-SC	1¾" rigid entry boot for flat sump surfaces
RDEB-175-SC	1¾" ducted rigid entry boot for flat sump surfaces
REB-R-175-SC	1¾" rigid entry boot for round sump surfaces
RDEB-R-175-SC	1¾" ducted rigid entry boot for round sump surfaces
REB-200-SC	2" rigid entry boot for flat sump surfaces
RDEB-200-SC	2" ducted rigid entry boot for flat sump surfaces
REB-R-200-SC	2" rigid entry boot for round sump surfaces
RDEB-R-200-SC	2" ducted rigid entry boot for round sump surfaces
408051001	1½" pipe seal
408052001	1¾" pipe seal
408042001	2" pipe seal
408055001	1½" pipe snap fit body insert
408056001	1¾" pipe snap fit body insert
408058001	1½" compression nut insert
408059001	1¾" compression nut insert
408069001*	Plastic adapter for curved sump

*Used to convert a flat sump surface rigid entry boot into a round sump surface rigid entry boot.



franklinfueling.com
 3760 Marsh Rd. • Madison, WI 53718, USA
 Tel: +1 608 838 8786 • Fax: +1 608 838 6433
 Tel: USA & Canada +1 800 225 9787 • Tel: UK +44 (0) 1473 243300
 Tel: Mex 001 800 738 7610 • Tel: DE +49 6571 105 380 • Tel: CN +86 10 8565 4566

